

HKB-JDBB 自润滑翻边轴套

HKB-JDBB Metric Flange Bushes

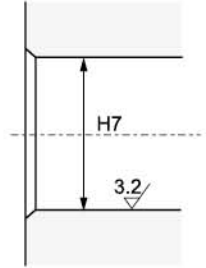
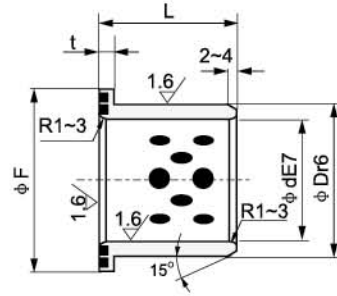
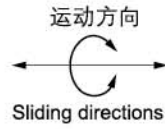

Mating Housing
相配座孔

单位Unit: mm

内径		外径		法兰			长度 L ^{-0.1} / _{-0.3}									
∅ d	公差	∅ D	公差	∅ F	t	公差	10	11	12	13	15	18	20	23	25	
6	+0.032 +0.020	10	+0.028 +0.019	20			0610	0611	0612							
8	+0.040 +0.025	12	+0.034 +0.023	25	3				0812	0813	0815					
10		14							1013		1018					
12		18		30	3			1211				1218		1223		
13		19								1313		1318		1323		
15	+0.050 +0.032	21		35					1513		1518		1523			
16		22	+0.041 +0.028					0 -0.03			1613		1618		1623	1625
18		24		40							1818		1823			
20		28		45									2020		2025	
25	+0.061 +0.040	33		50	5								2520		2525	
30		38	+0.050 +0.034				55								3020	
35		44		65								3520		3525		
40	+0.075 +0.050	50		70	7											
50		62	+0.060 +0.041	90	8											
60		74	+0.062 +0.043	110												
70	+0.090 +0.060	85	+0.073 +0.051	120	10	0 -0.04										
80		96		140												

HKB-JDBB 自润滑翻边轴套 HKB-JDBB Metric Flange Bushes



材质	高力黄铜 + 固体润滑剂
Material	650#+Graphite

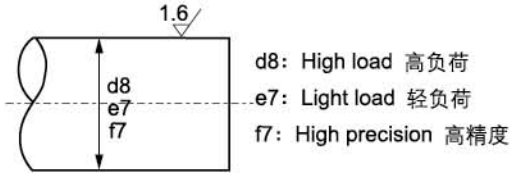

d8: High load 高负荷
e7: Light load 轻负荷
f7: High precision 高精度

Mating Shaft
相配轴

单位Unit: mm

长度 L $\begin{smallmatrix} -0.1 \\ -0.3 \end{smallmatrix}$												压入后 内径公差	内径 Ø d	
27	35	37	38	47	48	50	58	60	68	80	90			
													+0.016 +0.004	6
													+0.021 +0.006	8
														10
													+0.031 +0.013	12
														13
													+0.026 +0.008	15
														16
														18
													+0.037 +0.016	20
													+0.032 +0.011	25
	3035													30
	3535													35
4027		4037		4047									+0.046 +0.021	40
			5038		5048		5058						+0.040 +0.015	50
			6038		6048		6058		6068				+0.053 +0.023	60
						7075				7080			+0.046 +0.016	70
								8060			8090			80